

REV.	DESCRIPTION	DATE	APPROVED
F	Corrected Board Thickness	04/01/14	J. C.
G	Engineering Release	04/01/14	J. C.
H	Removed BOM	08/09/16	J. C.

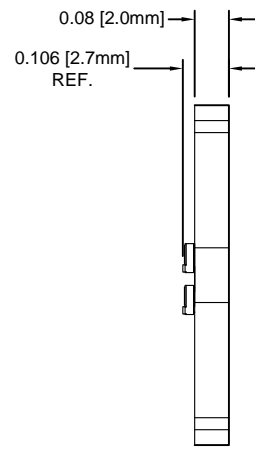
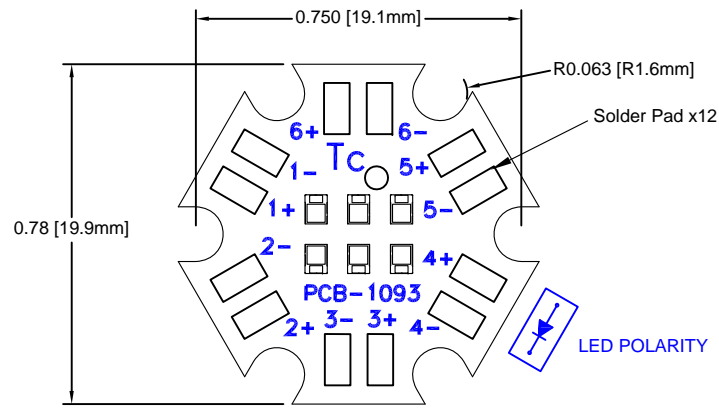

ORDERING INFORMATION
L24-ZXXXXK6
 _____ CORRELATED COLOR TEMPERATURE IN KELVIN

Table 1: Assembly Configurations					
Part Number	LED P/N	Color	CCT (K)	Typical Luminous Flux (lm)	Philips Lumileds P/N Reference
L24-Z3000K6	BDL-1510	Warm White	3000	660	LXZ1-3080-5
L24-Z5700K6	BDL-1513	Cool White	5700	840	LXZ1-5770

STANDARD TOLERANCE (UNLESS OTHERWISE SPECIFIED)		 4 THOMAS, IRVINE, CA. 92618 TEL: (949) 951-8808 FAX: (949) 951-3974	
DECIMALS	ANGULAR		
.X ± .1	X° ± 1°	 TITLE: L24 Starboard Light Engine	
.XX ± .02			
.XXX ± .010			
DESIGNED: B. Oliver	DATE: 11/07/13	PART NO: L24-ZXXXXK6	REVISION: H
CHECKED: J. Chiang	DATE: 11/07/13	CAGE CODE : 32559	SHEET # 1 OF 1
CAD GENERATED DOCUMENT. DO NOT MEASURE DRAWING.			